



RF&P Caboose #905

Have you ever listened to the sound of a locomotive whistle calling through the night air? Did it take you back to your childhood? Perhaps you and your grandfather used to watch trains. Perhaps the whistle's unique wail reminded you of pleasant and exciting travel experiences. Have you ever waved at the crew of a passing train? Come on, admit it. Of course you have. Did you imagine your model train as its full size counterpart? Fun wasn't it.

## Who we are

We are the Rappahannock Chapter, Inc. of the National Railway Historical Society (NRHS), a not-for-profit organization dedicated to railroad history, preservation, education, fellowship and entertainment. The Chapter was chartered in April, 1989 and is supported by members' dues and donations.

## Join Us!

Join us in our efforts to maintain a small piece of railroad history. Learn about the historical importance of the railroads. Share your interest and your thirst for knowledge. You can participate in rail excursions and many interesting projects both on real railroad equipment, and in miniature, while helping to educate the community. Some of the Chapter's rail excursions are to destinations not usually open to the general public. Membership in the Chapter is open to everyone. Annual dues also make you a member of the National Railway Historic Society as well as the Rappahannock Chapter.



Norfolk & Western Caboose #518620

## Meetings and Events

You're invited to attend our meetings to see what we are all about. Participate in the fellowship our Chapter has to offer. Enjoy interesting speakers and some great presentations and have a look at our Chapter newsletter, *The Mail Pouch*, or drop by our Museum some Saturday morning.

### Monthly Business Meeting

7:00 pm, Second Thursday at the Central Rappahannock Regional Library, 2607 Salem Church Rd, Fredericksburg, VA, 22407

### Weekly Activities

9:00 am - Noon Each Saturday at the Rappahannock Railroad Workers' Museum, 11700 Main St, Fredericksburg, VA, 22408.

### Annual Activities

(Check web site for times and dates)

- St. Patrick's Day Parade
- Octoberfest
- Open House
- Spring Flower and Fall Leaf Rides
- Trains at Christmas (Model Train and Railroadiana - show and sale)

## The Rappahannock Railroad Workers' Museum

The railroad equipment that the Chapter is currently preserving includes:

- RF&P Caboose #905
- Norfolk & Western Caboose #518620
- Pennsylvania B60b Baggage Car #9325
- Pennsylvania Box Car #112171



Pennsylvania Baggage Car #9325

We have also accumulated an extensive collection of historical and nostalgic railroad related items including dining car china, railroad uniforms, lanterns and marker lights, which is slated to be included in the Rappahannock Railroad Workers' Museum.

### Directions to the Museum

11700 Main Street  
Fredericksburg, VA 22408  
From Business US-17 / VA-2 turn onto Joseph Mills Dr and then left at Main Street. The Museum will be in the rail yard on your left. The museum is open most Saturdays between 9:00 am and noon. (See web site for details.)

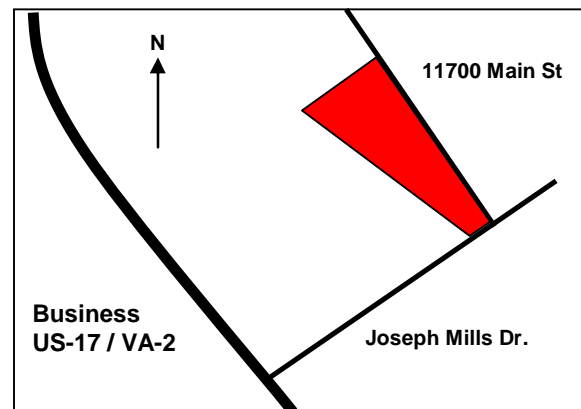

## Some Local Railroad History

### Richmond, Fredericksburg & Potomac Railroad (RF&P RR)

Richmond to Washington, DC. 1834-1991, currently part of CSX. This railroad was divided at Fredericksburg during the Civil War. Cars were carried on barges between Aquia Creek and Alexandria, VA until 1877.



Pennsylvania Box Car #112171

### Potomac, Fredericksburg and Piedmont Railroad (PF&P RR)

Fredericksburg to Orange, 1876 - 1926. 38 miles, Three-foot narrow gauge.

### Virginia Central Railway (VC Ry)

Fredericksburg, 1926-1937 38 miles. Reduced to 1.5 miles 1937-1984, All Standard Gauge, Formerly PF&P RR.

### Dahlgren Military Railroad (DM RR)

Fredericksburg to Dahlgren, 1942-1957, 27 miles.

### Some Historic Trackside Industries at Fredericksburg

included pickle works, coal yards, gas works, stock yards, fertilizer distributors, a scrap metal yard, grain elevators, ice plants, a planing mill and box factory.

### During the Civil War

The Civil War divided the RF&P Railroad at Fredericksburg, and the railroad ran between the front lines at Slaughter Pen Farm during the Battle of Fredericksburg which involved 200,000 combatants and 17,000 casualties. During the war years, the 600' bridge over the Rappahannock was rebuilt five times. The Federals used the northern part, the US Military Railroad, to transport up to 169,000 men and 60,000 animals for battle near Fredericksburg, and over 10,000 slaves on their "Trail to Freedom." Meanwhile the Confederates controlled the line between Hamilton's Crossing and Richmond. General Stonewall Jackson also exploited roadbed prepared for the 'unbuilt' PF&P Railroad.

## The Little Yellow Train



Little Yellow Train Switching Operation

The Rappahannock Chapter has preserved a variety of small maintenance-of-way equipment including two powered speeders (RF&P #MR43 and C&O #M1892), a B&O crew car #501 and two flat cars. Come ride with us to the main line and watch switching and signaling operations. Rides on the historic equipment may be available depending on weather, commercial rail activity and crew availability between March 15 and October 31. Please see web site for details.



Little Yellow Train at Museum Yard

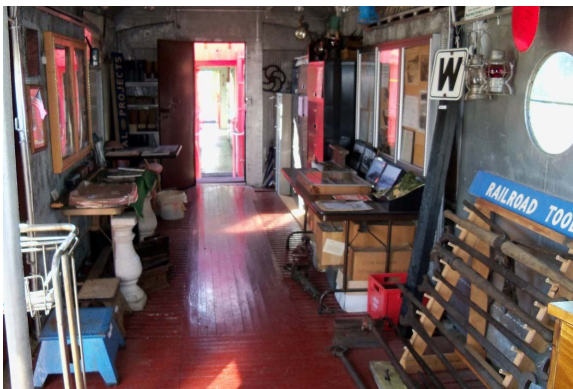

Museum Baggage Car Interior



A Little Yellow Train Excursion

## Model Railroading

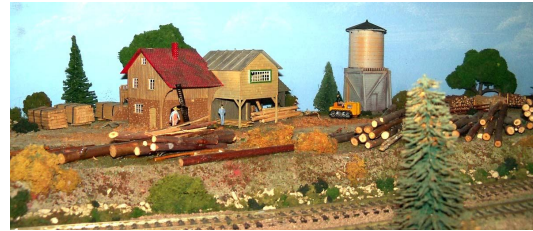

Saw Mill Model

The Chapter maintains modular layouts in

- O-gauge (3-rail) 1:48
- HO-scale 1:87
- N-scale 1:160

Some members also have layouts in On30 scale 1:48 narrow gauge and G-scale 1:22.5



Museum Yard Model

## Opportunities

- Meet fellow rail fans
- Help restore historic prototype equipment by making a donation of your time and effort
- Learn railroad and trackside industry history
- Educate the community concerning its rail heritage and our Chapter's specific efforts to preserve a small piece of it
- Collect railroad artifacts
- Work on the model railroad layouts
- Contribute articles, photos or other memorabilia to the Chapter's newsletter, monthly programs or our oral history program

# The Rappahannock Chapter

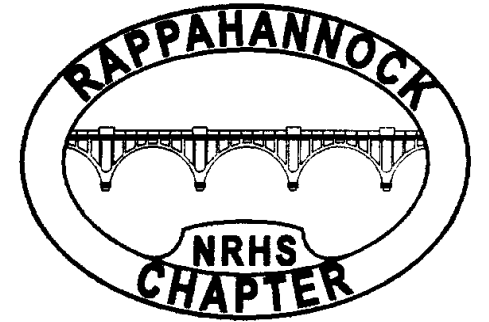

of the  
**National Railway  
Historical Society**

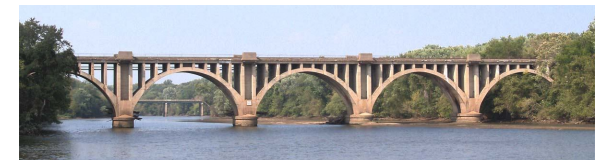

[www.rcnrhs.com](http://www.rcnrhs.com)

Rappahannock Chapter, Inc.  
National Railway Historical Society  
P. O. Box 9088  
Fredericksburg, VA 22403-9088